

Top View of Assembly

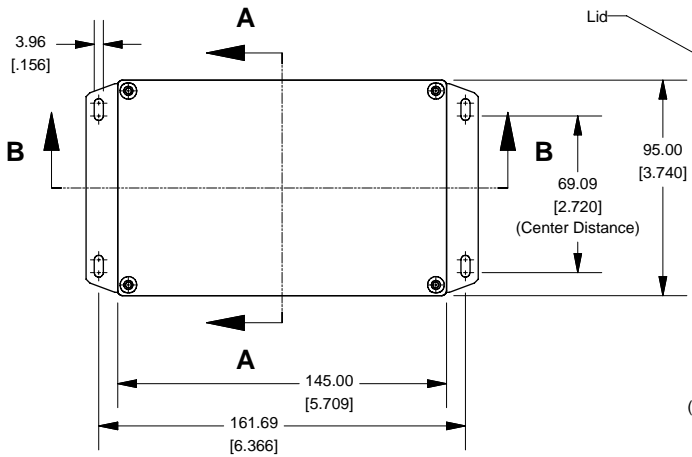

SECTION A-A End View of Assembly

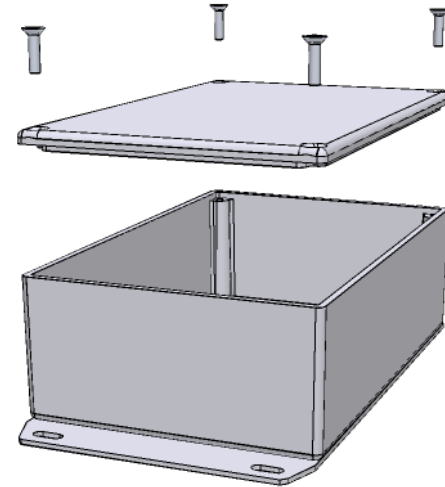
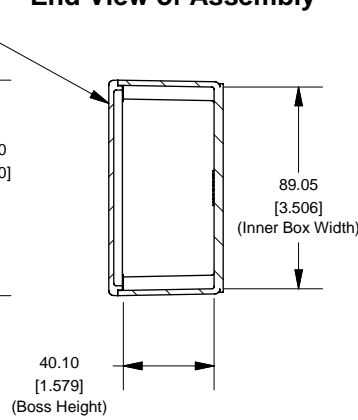

SECTION B-B Side View of Assembly

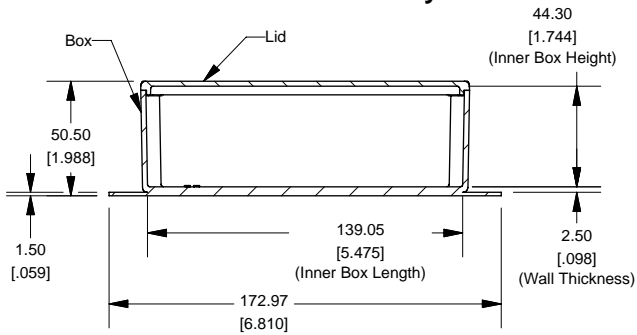

Top View Looking Inside Box

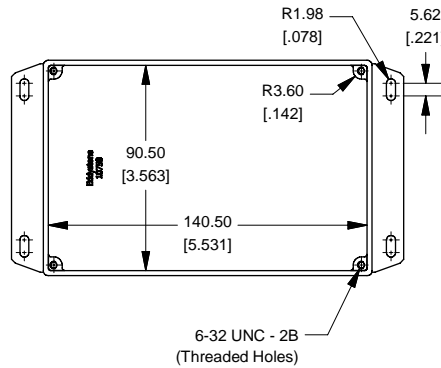

Lid

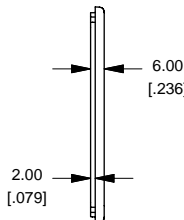
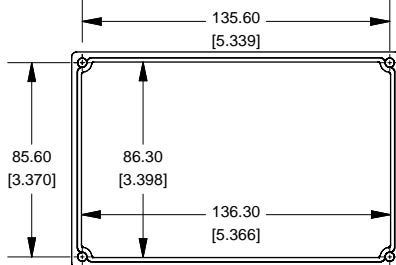

Enclosures can be Factory Modified (Milling, Drilling, Printing etc.)
 Contact Factory mjm@hammondmfg.com for quotes
 Solid models of this enclosure available in STEP or IGES.

NOTE

Purchased assembly includes box, lid and 4 cover screws.
 Box and lid are made from Diecast Aluminum Alloy (alloy type 380).
 Silicone Gasket Loctite #5950

PART NUMBERS

1590JF Enclosure	
Unfinished	1590JF
Black Textured Polyester Powder Paint - RAL 7038	1590JFGY
Black Textured Polyester Powder Paint - RAL 9011	1590JFBK
1590JF Liquid Resistant Enclosure (Silicon Factory Installed Gasket)	
Unfinished	1590WJF
Black Textured Powder Paint	1590WJFBK
ACCESSORIES	
Recommended Torque: 75 ozf.in / 55 cN.m	
Cover Screws (Pkg 100) [6-32 x 1/2" Nickel Plated Screws]	1590MS100
Black Textured Powder Paint	
Cover Screws (Pkg 50) [6-32 x 1/2" SS Type 304]	1590MS50BK



**HAMMOND
MANUFACTURING™**

1590JF

www.hammondmfg.com