

**STEP 1:**  
Locate cagenut as shown on back side of rail.

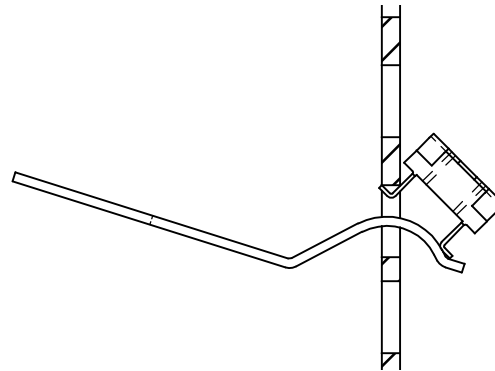

**STEP 2:**  
Insert RCNIT through hole and hook onto bottom lip of cage nut.

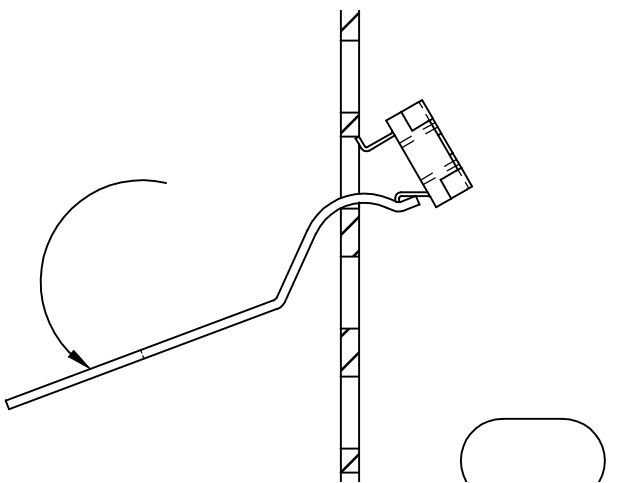

**STEP 3:**  
Rotate RCNIT down.

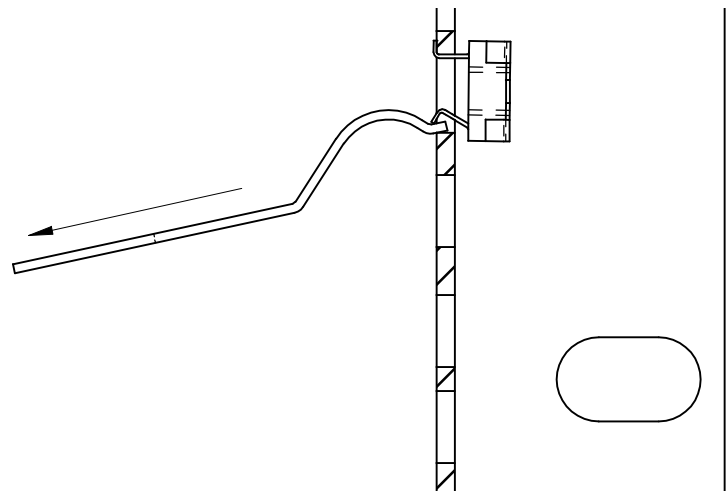

**STEP 4:**  
As you rotate the RCNIT down pull the RCNIT back through the hole.

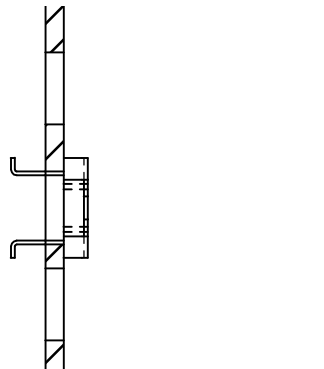

Cage nut fully positioned

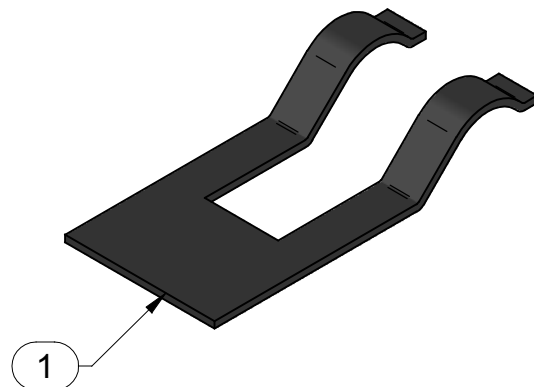

PARTS LIST		
ITEM No.	DESCRIPTION	QTY
1	CAGE NUT INSERTION TOOL	1