

# N1WS Series Surface Mount Panel Enclosure

3 Piece Assembly - NEMA 1



Commercial Enclosures

## Application

- Designed for indoor use to enclose controls, instruments, and components which do not require oil-tight or dust-tight protection.
- Ideal for applications where components may be easily mounted and wired prior to installation of wrapper and door.

## Standards

- UL 50 Type 1
- CSA Type 1
- **Complies with**
  - NEMA Type 1
  - IEC 60529, IP20

## Construction

- Three piece assembly consisting of a base, wrapper, and door.
- Components are attached and secured with metal screws.
- 14 gauge reverse formed base provides clearance for mounting hardware.
- Wrapper is available in three depths: 4", 6", and 8".
- Wrapper is formed from 16 gauge steel, with no knock-outs in the sides.
- Door assembly formed from 16 gauge steel.
- Removable door is mounted on slip hinges.
- A bonding stud is provided on the door and a grounding screw is provided for the enclosure.
- Door is fastened with a slotted quarter turn latch.

## Finish

- Base, wrapper and door are finished in ANSI 61 gray powder coating.

## Accessories

- Surface lock kit (Part No. N1JLK)  
...see page **431**
- Padlock Adaptor (Part No. EJPA)  
...see page **435**

Panel Enclosures

# N1WS Series Surface Mount Panel Enclosure

## 3 Piece Assembly - NEMA 1

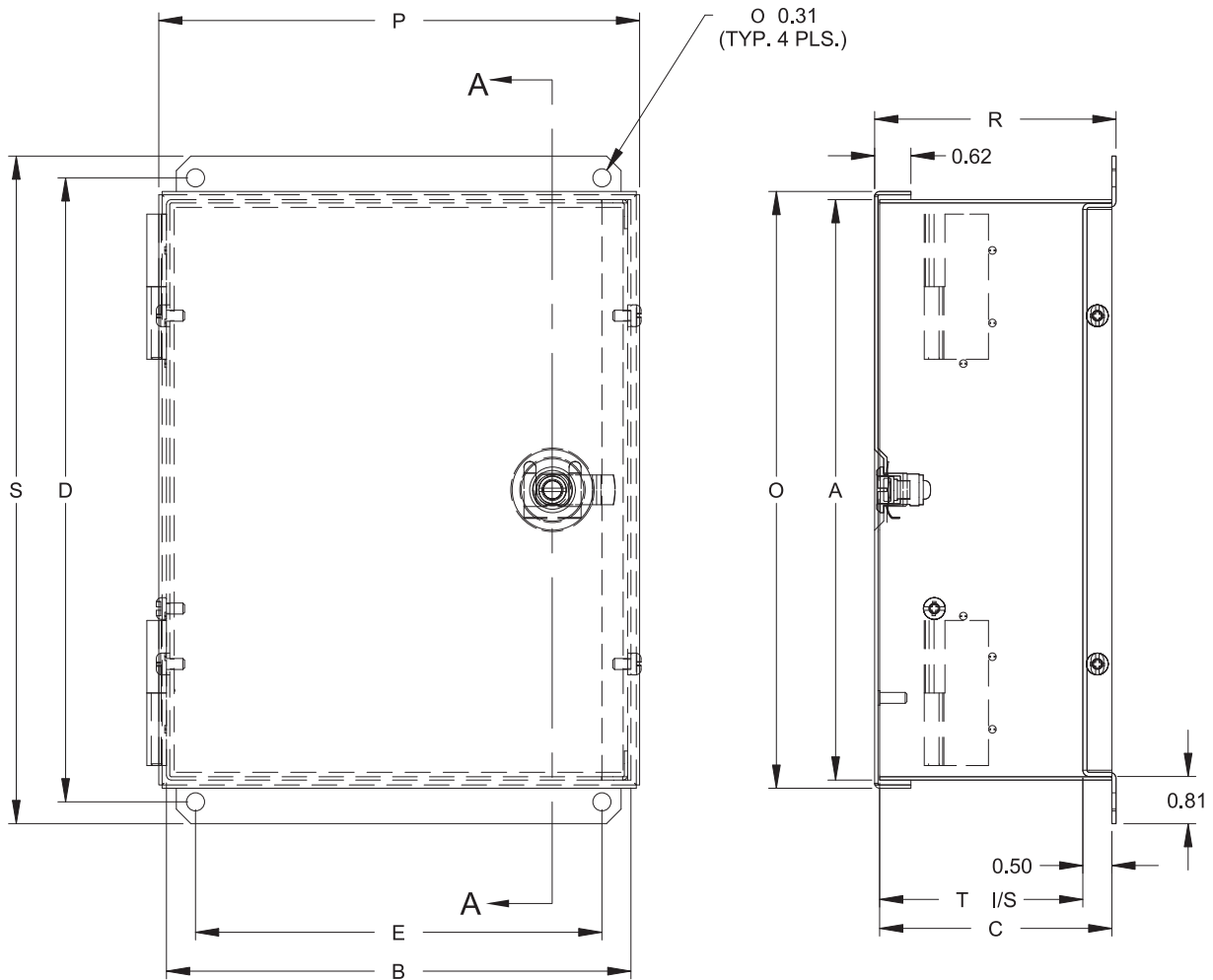

**Front View**

**Side View**

Part No.	Wrapper Size	Mounting Centers					Overall Dimensions				Ship Wt. Lbs.	
		A	B	C	D	E	P	R	S	T		O
<b>N1WS864</b>	4" Deep	8	6	4	8.75	5	6.28	4.16	9.5	3.5	8.28	5
<b>N1WS1084</b>		10	8	4	10.75	7	8.28	4.16	11.5	3.5	10.28	7
<b>N1WS12104</b>		12	10	4	12.75	9	10.28	4.16	13.5	3.5	12.28	10
<b>N1WS16124</b>		16	12	4	16.75	11	12.28	4.16	17.5	3.5	16.28	14
<b>N1WS20164</b>		20	16	4	20.75	15	16.28	4.16	21.5	3.5	20.28	20
<b>N1WS24204</b>		24	20	4	24.75	19	20.28	4.16	25.5	3.5	24.28	28
<b>N1WS866</b>	6" Deep	8	6	6	8.75	5	6.28	6.16	9.5	5.5	8.28	6
<b>N1WS1086</b>		10	8	6	10.75	7	8.28	6.16	11.5	5.5	10.28	9
<b>N1WS12106</b>		12	10	6	12.75	9	10.28	6.16	13.5	5.5	12.28	11
<b>N1WS16126</b>		16	12	6	16.75	11	12.28	6.16	17.5	5.5	16.28	16
<b>N1WS20166</b>		20	16	6	20.75	15	16.28	6.16	21.5	5.5	20.28	22
<b>N1WS24206</b>		24	20	6	24.75	19	20.28	6.16	25.5	5.5	24.28	31
<b>N1WS868</b>	8" Deep	8	6	8	8.75	5	6.28	8.16	9.5	7.5	8.28	7
<b>N1WS1088</b>		10	8	8	10.75	7	8.28	8.16	11.5	7.5	10.28	10
<b>N1WS12108</b>		12	10	8	12.75	9	10.28	8.16	13.5	7.5	12.28	13
<b>N1WS16128</b>		16	12	8	16.75	11	12.28	8.16	17.5	7.5	16.28	18
<b>N1WS20168</b>		20	16	8	20.75	15	16.28	8.16	21.5	7.5	20.28	26
<b>N1WS24208</b>		24	20	8	24.75	19	20.28	8.16	25.5	7.5	24.28	34

Commercial Enclosures

Panel Enclosures

Technical references and CAD downloads available at [www.hammondmfg.com](http://www.hammondmfg.com)

All dimensions in inches unless specified otherwise

**Quality Products. Service Excellence.**